



CONTACTOR, AC-3 15 KW/400 V, AC 24 V,  
50 HZ, 3-POLE, SIZE S2, SCREW CONNECTION

### General details:

Product brand name		SIRIUS
Product designation		power contactor
Size of the contactor		S2
Protection class IP / on the front		IP20
Degree of pollution		3
Installation altitude / at a height over sea level / maximum	m	2000
Ambient temperature / during the operating phase	°C	-25 ... 60
Active power loss / per conductor / typical	W	1.8
Item designation		
<ul style="list-style-type: none"> <li>• according to DIN EN 61346-2</li> <li>• according to DIN 40719 extendable after IEC 204-2 / according to IEC 750</li> </ul>		Q K
Mechanical operating cycles as operating time		
<ul style="list-style-type: none"> <li>• of the contactor / typical</li> <li>• of the contactor with added auxiliary switch block / typical</li> <li>• of the contactor with added electronics-compatible auxiliary switch block / typical</li> </ul>		10000000 10000000 5000000

### Main circuit:

Number of poles / for main current circuit		3
--	--	---

<b>Number of NC contacts / for main contacts</b>		0
<b>Number of NO contacts / for main contacts</b>		3
<b>Operating current / at AC-1 / at 400 V / at 40 °C ambient temperature / rated value</b>	A	50
<b>Operating current / at AC-1 / at 400 V / at 60 °C ambient temperature / rated value</b>	A	45
<b>Operating current</b>		
• at AC-3 / at 400 V / rated value	A	32
• with 1 current path		
• at DC-1		
• at 24 V / rated value	A	45
• at 110 V / rated value	A	4.5
• at DC-3 / at DC-5		
• at 24 V / rated value	A	35
• at 110 V / rated value	A	2.5
• with 2 current paths in series		
• at DC-1		
• at 24 V / rated value	A	45
• at 110 V / rated value	A	45
• at DC-3 / at DC-5		
• at 24 V / rated value	A	45
• at 110 V / rated value	A	25
• with 3 current paths in series		
• at DC-1		
• at 24 V / rated value	A	45
• at 110 V / rated value	A	45
• at DC-3 / at DC-5		
• at 24 V / rated value	A	45
• at 110 V / rated value	A	45
<b>Service power</b>		
• at AC-1 / at 400 V / rated value	kW	31
• at AC-2 / at 400 V / rated value	kW	15
• at AC-3		
• at 400 V / rated value	kW	15
• at 500 V / rated value	kW	18.5
• at 690 V / rated value	kW	18.5
<b>Control circuit:</b>		
<b>Design of activation of the operating mechanism</b>		conventional
<b>Type of voltage / of the controlled supply voltage</b>		AC
<b>Control supply voltage frequency</b>		

• 1 / rated value	Hz	50
<b>Control supply voltage / 1</b>		
• at 50 Hz / for AC		
• rated value	V	24

#### Auxiliary circuit:

<b>Contact reliability / of the auxiliary contacts</b>		1 faulty switching per 100 million (17 V, 1 mA)
<b>Number of NC contacts / for auxiliary contacts</b>		
• instantaneous switching		0
• lagging switching		0
<b>Number of NO contacts / for auxiliary contacts</b>		
• instantaneous switching		0
• leading switching		0
<b>Operating current / of the auxiliary contacts</b>		
• at AC-12 / maximum	A	10
• at AC-15		
• at 230 V	A	6
• at 400 V	A	3
• at DC-12		
• at 60 V	A	6
• at 110 V	A	3
• at 220 V	A	1
• at DC-13		
• at 24 V	A	10
• at 60 V	A	2
• at 110 V	A	1
• at 220 V	A	0.3

#### Short-circuit:

<b>Design of the fuse link</b>		
• for short-circuit protection of the auxiliary switch / required		fuse gL/gG: 10 A
• for short-circuit protection of the main circuit		
• with type of assignment 1 / required		fuse gL/gG: 125 A
• at type of coordination 2 / required		fuse gL/gG: 63 A

#### Installation/mounting/dimensions:

<b>Type of mounting</b>		screw and snap-on mounting onto 35 mm standard mounting rail according to DIN EN 50022
<b>series installation</b>		Yes
<b>Width</b>	mm	55
<b>Height</b>	mm	112

Depth	mm	115
Distance, to be maintained, to earthed part / sideways	mm	6

#### Connection type:

##### Design of the electrical connection

- for main current circuit
- for auxiliary and control current circuit

screw-type terminals

screw-type terminals

#### Certificates/approvals:

##### General Product Approval

##### Functional Safety / Safety of Machinery

##### Test Certificates

[CQC](#)



[KETI](#)



[SUVA](#)

[Manufacturer](#)

##### Shipping Approval

[ABS](#)



##### Shipping Approval

other



[Manufacturer](#)

[other](#)

#### Further information:

##### Information- and Downloadcenter (Catalogs, Brochures,...)

<http://www.siemens.com/industrial-controls/catalogs>

##### Industry Mall (Online ordering system)

<http://www.siemens.com/industrial-controls/mall>

##### CAX-Online-Generator

<http://www.siemens.com/cax>

##### Service&Support (Manuals, Certificates, Characteristics, FAQs,...)

<http://support.automation.siemens.com/WW/view/en/3RT1034-1AB00/all>

##### Image database (product images, 2D dimension drawings, 3D models, device circuit diagrams, ...)

[http://www.automation.siemens.com/bilddb/cax\\_en.aspx?mlfb=3RT1034-1AB00](http://www.automation.siemens.com/bilddb/cax_en.aspx?mlfb=3RT1034-1AB00)

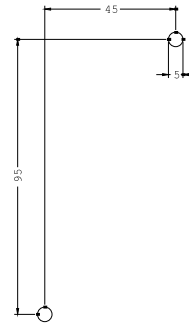
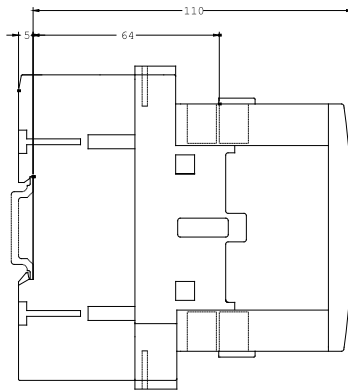
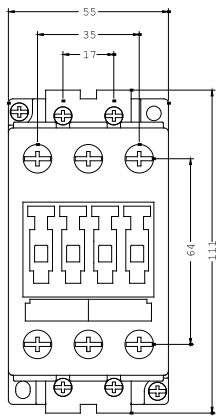

last change:

Oct 25, 2010